

AP MORGAN



Greenslade Croft, Northfield, Birmingham
£995 per month

Features:

- Well-presented semi-detached house
- Two double bedrooms
- Spacious lounge/dining area
- Convenient sized kitchen
- Stylish shower room
- Good sized rear garden
- Multi-car driveway
- EPC- D

Description:

Available from mid-May, this well-presented, two-bedroom semi-detached house has accommodation comprising:

Ground floor: entrance hall, lounge/dining room, convenient sized kitchen with integrated oven and hob, lean to with space for freestanding appliances.

First floor: Landing with storage cupboard, two double bedrooms, stylish shower room with WC, wash hand basin and walk-in shower cubicle.

To the front: Multi car driveway with side door for access into lean to.

To the rear: a raised decking area, accessed via a rear door from the dining room, and lawn with fenced surround and several plants and foliage.

Especially of note is the quiet cul-de-sac location and white goods being included with the rental.

Located within Northfield, this is a particularly popular area for families and professionals with local amenities including shops, schools, parks and national transport links accessed via the bus, rail and motorway networks.



Details:

Hallway

Lounge/Diner 21'6" x 11'5" (6.55m x 3.48m)

Kitchen 9'8" x 8'4" (2.95m x 2.54m)

Lean To

Landing

Bedroom One 14'7" x 9'11" (4.45m x 3.02m)

Bedroom Two 11'3" x 9'3" (3.43m x 2.82m)

Shower Room 7'10" x 5'2" (2.4m x 1.57m)

EPC Rating: D

Council Tax Band: (tbc by solicitors).

Tenure: To be advised (tbc by solicitors).

For more information or to arrange a viewing, please call us on 01384 319 400.

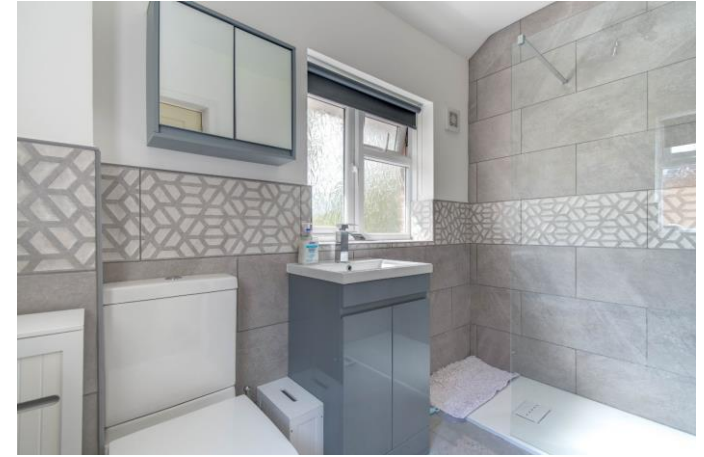

How can we help you?

Need a mortgage?

We recommend Wiser Mortgage Advice. They will search the market for you to ensure you get the right lender and mortgage deal. They typically achieve mortgage offers much more quickly than if you were dealing with lenders directly.

The initial appointment is free and without obligation. Call us on 01384 319 400, or visit their website for more information: www.wisermortgageadvice.co.uk

Property to sell?

If you need to sell a property in order to buy, you ideally need to be on the market at least (and preferably Sold STC) before viewing, otherwise you may lose out to other buyers when the right property comes along. In these circumstances we can get your property 'live' quickly. Just book a free valuation and we will visit your property and discuss your needs.

Need a solicitor?

A good solicitor can save you literally weeks of time in the buying/selling process, reducing the stress levels of all involved. We will instruct a reputable firm that is competitive on cost and very reliable. Just ask for a quote.

Need a removal company and storage?

A professional removal company takes the stress out of moving, knowing that your belongings are safe and insured far outweighs any small savings by trying to do it yourself or using a man-and-a-van service. We work closely with and recommend Cube Removals as the leading local firm. For peace of mind and a reliable service call them on 0800 193 0000 or visit their website, cuberemovals.co.uk, to arrange a survey.

GROUND FLOOR (40.9 sq.m.) approx.

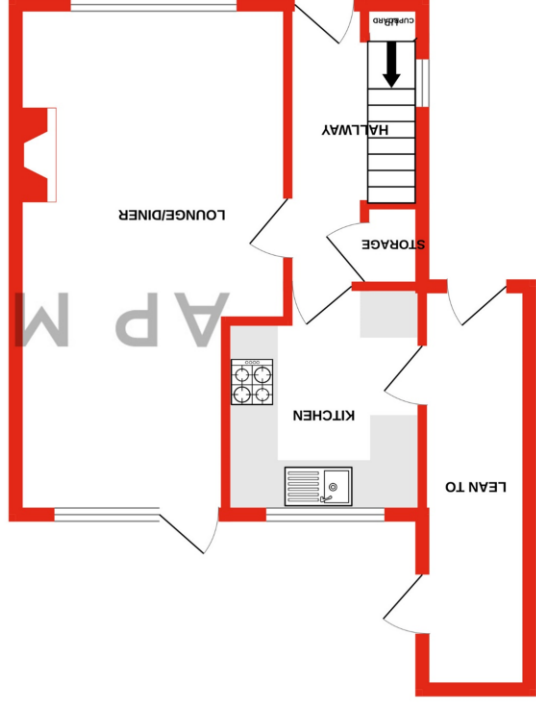

1ST FLOOR (34.3 sq.m.) approx.

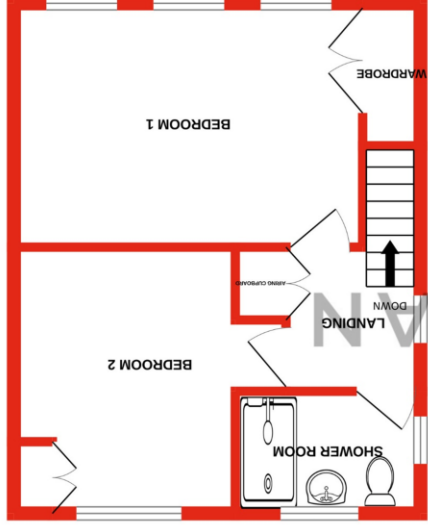

TOTAL FLOOR AREA - 810 sq.ft. (75.3 sq.m.) approx.

While every attempt has been made to ensure the accuracy of the floorplan contained here, measurements of doors, windows, rooms and any other items are approximate and no responsibility is taken for any error, omission or mis-statement. This plan is for illustrative purposes only and should be used as such by any prospective purchaser. The services, systems and appliances shown have not been tested and no guarantee as to their operability or efficiency can be given.

Made with Metropix ©2024

No statement in these details is to be relied upon as representation of fact, and purchasers should satisfy themselves by inspection or otherwise as to the accuracy of the statements contained within. These details do not constitute any part of any offer or contract. AP Morgan and their employees and agents do not have any authority to give any warranty or representation whatsoever in respect of this property. These details and all statements herein are provided without any responsibility on the part of AP Morgan or the vendors. Equipment: AP Morgan has not tested the equipment or central heating system mentioned in these particulars and the purchasers are advised to satisfy themselves as to the working order and condition. Measurements: Great care is taken when measuring, but measurements should not be relied upon for ordering carpets, equipment, etc. The Laws of Copyright protect this material. AP Morgan is the Owner of the copyright. This property sheet forms part of our database and is protected by the database right and copyright laws. No unauthorised copying or distribution without permission.